

X99S GAMING 7

GAMING PERFECTION



TURBO U.2 HOST CARD



[f Share](#) [T](#) Tweet +1

- Supports U.2 interface SSD with NVMe driver
- U.2 redriver: The signal amplifier for better performance
- The best compatibility: Compatible for all M.2 slot in PCI-E mod
- Maximum Bandwidth: PCI-E 3.0 x4 (up to 32 Gb/s)
- Input Interface: M.2 (Key M)
- Output Interface: U.2 Host Connector up to 32 Gb/s
- Compatible OS: Windows 7, 8, 8.1, 10
- Compatible for M.2 2280 slot



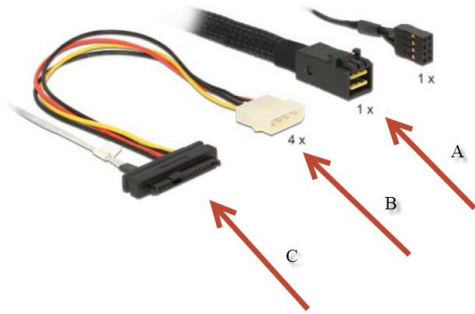

Connecting the cable (LTO-7, LTO-6, and LTO-5)

If you are installing the tape drive in an enclosure using the cable that came with the enclosure, skip this section and follow the instructions included with the enclosure to cable the drive.

To connect the cable that came with the tape drive to a server or enclosure:

1. Connect the combined SAS and power connector to the tape drive port.
2. Connect the SAS connector without the cover to the host port, which could be on an HBA or on the controller board.

Leave the cover on the unused SAS connector.

3. Plug the power connector into the power supply cabling.

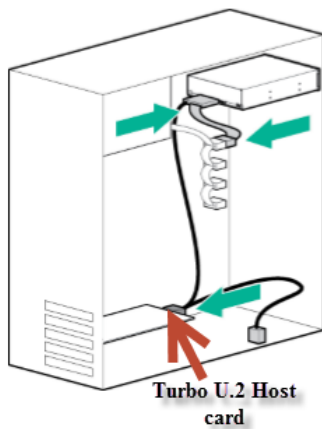

Although there is power on the HP6250 LTO-6 Ultrium, whatever settings I use in the Bios for the M.2 port, the tape drive is not found in either the BIOS or Windows 10.

